

Clinician Office Spaces

A collection of thought starter ideas

New Relationships and New Behaviors

For more than a decade, Steelcase Health has delved into the published literature and undertaken our own primary research to better understand the realities and opportunities that all healthcare organizations face. We've studied a broad spectrum of facilities, observing and documenting everyday processes and interactions in real time.

This research has led to our deep understanding of healthcare experiences and spaces. As we continue to learn and synthesize our findings, we gain new insights into how healthcare organizations can achieve their goals by fully leveraging the power of place.

Our understanding of how place can best accomplish this is based on:

- Understanding the challenges of healthcare organizations
- Designing for the human factor
- Integrating the experiences of healthcare

<https://www.steelcase.com/resources/documents/designing-quadruple-aim-booklet-poster/>



23 INVESTIGATIONS COMPLETED
52 HEALTHCARE FACILITIES STUDIES
15,280 HOURS OF OBSERVATIONAL RESEARCH

NEW INSIGHTS

Medical Office Spaces

Steelcase is passionate about bringing human insights to healthcare environments, and helping organizations perform better through the places where their people come together to work.

A fundamental shift has occurred in our world and the ways we work, and it's one that has profound impact on the places and spaces where we work. We believe that the workplace is more important than ever before, and that it can be a key strategic business tool, but only if it's designed to support the ways people and organizations work today.



PRIVATE OFFICE 1



Concept

This space functions as both a private office and consultation space. This allows clinicians to maximize efficiency. Digital and analogue technology are present, allowing all users to engage in this environment. the space functions as both a private office and consultation space

PRIVATE OFFICE 1

PO_1A

Application Includes

- Mackinaw workspace
- Think chair
- Motif wall panel
- Qivi chair
- Ancillary additions*
- Double Tuck Felt Basket, Blu Dot
- 2D:3D Small Bowl, Blu Dot

Details

1. Blending both standing and seated height solutions provides users a healthy palette of posture and choice on how to work.
2. Often, sensitive information needs to be shared in private. Casper cloaking technology hides screens within a room allowing sensitive content to be displayed privately, while still maintaining access to natural light.



* Steelcase Health brand items are tested to BIFMA standards, are HHI compliant and are designed to be clinically appropriate and support patient safety and infection prevention protocols. However, some of the ancillary items shown in this application may or may not be appropriate for your specific clinical space or adhere to your facilities cleaning protocols. Please weigh each of these ancillary items on their own merit for use in your facility.

PRIVATE OFFICE 1

PO_1B

Application Includes

- Mackinaw workspace
- Think chair
- Motif wall panel
- Qivi chair
- Ancillary additions*
- Double Tuck Felt Basket, Blu Dot
- 2D:3D Small Bowl, Blu Dot

Details

1. Mackinaw's foundation and tower create a definition of space between heads down and consultation work.
2. Technology plays an important role in the consultation space. It is a tool used for both teaching and learning and should be able to be viewed by all users in the space.



* Steelcase Health brand items are tested to BIFMA standards, are HHI compliant and are designed to be clinically appropriate and support patient safety and infection prevention protocols. However, some of the ancillary items shown in this application may or may not be appropriate for your specific clinical space or adhere to your facilities cleaning protocols. Please weigh each of these ancillary items on their own merit for use in your facility.

PRIVATE OFFICE 2



Concept

In this concept, the space functions as both a private office and consultation space. Users have the option to have a quick conversation at the clinician's desk or move to a more comfortable lounge setting.

PRIVATE OFFICE 2

PO_2A

Application Includes

- Elective Elements workstation
- Elective Elements storage
- Embold seating
- Leap seating
- Designtex performance textiles

Details

1. Embold provides a comfortable and cleanable seat for guests without sacrificing beauty, making the space more aesthetically pleasing.
2. Elective Elements provides opportunity for a wardrobe tower, allowing clinicians space for coats and personal belongings.



PRIVATE OFFICE 2

PO_2B

Application Includes

- Elective Elements storage
- Embold seating
- Leap seating
- Free Stand table
- Designtex performance textiles
- Ancillary additions*
- Splash Coat Rack, Blu Dot
- Beau Table Lamp, Blu Dot
- Double Tuck Small Felt Basket, Blu Dot
- Mosaic 5X8 Rug, Mitchell Gold + Bob Williams

Details

1. This setting offers a familiar home-like feel within the space.
2. Free Stand table allows for either clinicians or patients to sit in a lounge posture while easily taking notes.
3. The Splash coat rack is a welcoming addition to any space as they offer to hold coats, purses and backpacks.

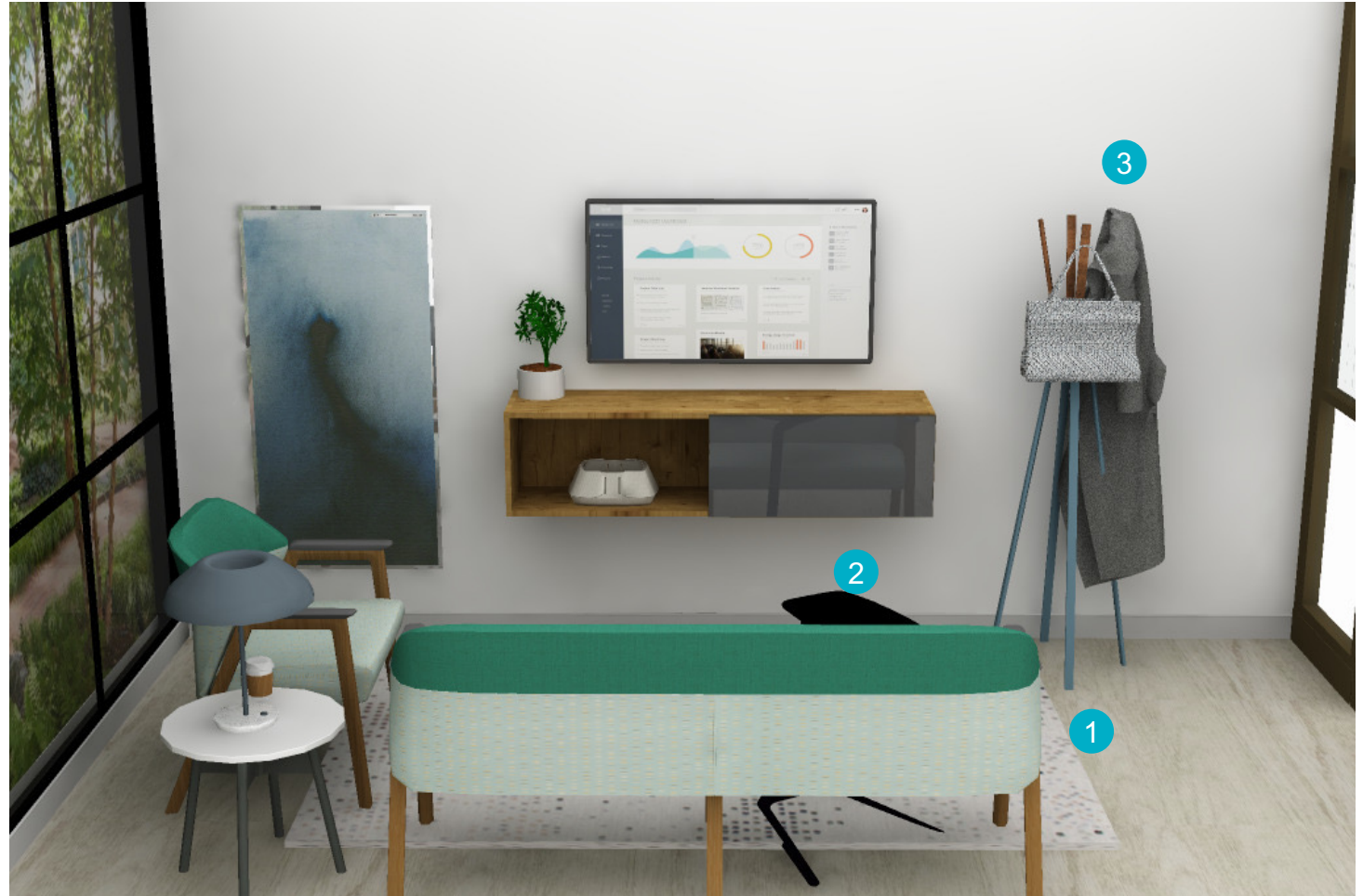

* Steelcase Health brand items are tested to BIFMA standards, are HHI compliant and are designed to be clinically appropriate and support patient safety and infection prevention protocols. However, some of the ancillary items shown in this application may or may not be appropriate for your specific clinical space or adhere to your facilities cleaning protocols. Please weigh each of these ancillary items on their own merit for use in your facility.

PRIVATE OFFICE 2

PO_2C

Application Includes

- Elective Elements workstation
- Elective Elements storage
- Embold seating
- Leap seating
- Free Stand table
- Designtex performance textiles
- Ancillary additions*
- Splash Coat Rack, Blu Dot
- Beau Table Lamp, Blu Dot
- Double Tuck Small Felt Basket, Blu Dot
- Mosaic 5X8 Rug, Mitchell Gold + Bob Williams

Details

1. Technology plays an important role in the consultation space. Clinicians have easy access to power and back painted glass allows users to jot down notes and “to-do’s”.

2. A small table provides a location for personal items or table.



PRIVATE OFFICE 3



Concept

This private office space provides a quiet workspace where the clinician can work. Additional chairs allow for small meetings with colleagues. Technology is used as a tool for both teaching and learning with access to all users in the space.

PRIVATE OFFICE 3

PO_3A

Application Includes

- Elective Elements storage
- Currency workstation
- Amia seating
- Bindu seating
- Motif wall panel
- V.I.A. modular wall
- Ancillary additions*
- Wook Wall Hook, Blu Dot
- Birdlandia Vines, Made to Measure, Designtex
- Half Dipped Vase, Big Bulb, West Elm
- Half Dipped Vase, Tall Tapered, West Elm

Details

1. Technology plays an important role in the exam space. It is a tool used for both teaching and learning and should be able to be viewed by all users in the space.
2. Often, sensitive information needs to be shared in private. Casper cloaking technology hides screens within a room allowing sensitive content to be displayed privately, while still maintaining access to natural light.



PRIVATE OFFICE 3

PO_3B

Application Includes

- Elective Elements storage
- Currency workstation
- Amia seating
- Bindu seating
- Motif wall panel
- V.I.A. modular wall
- Ancillary additions*
- Wook Wall Hook, Blu Dot
- Birdlandia Vines, Made to Measure, Designtex
- Half Dipped Vase, Big Bulb, West Elm
- Half Dipped Vase, Tall Tapered, West Elm

Details

1. Coat hooks are a thoughtful addition to the space for the storage of personal items.
2. Elective Elements' shelves provide an additional space to display personal items, incorporate greenery, and hold additional office supplies.



* Steelcase Health brand items are tested to BIFMA standards, are HHI compliant and are designed to be clinically appropriate and support patient safety and infection prevention protocols. However, some of the ancillary items shown in this application may or may not be appropriate for your specific clinical space or adhere to your facilities cleaning protocols. Please weigh each of these ancillary items on their own merit for use in your facility.

PRIVATE OFFICE 4



Concept

This shared office functions as a work and meeting space. Combining both functions in one shared space is a good way to maximize the real estate available. This setting offers a familiar home-like feel within the space.

PRIVATE OFFICE 4

PO_4A

Application Includes

- Convey modular casework
- Gesture seating
- Motif wall panel
- Joel seating
- Campfire Paper Table
- Ancillary additions*
- Splash Coat Rack, Blu Dot
- Double Tuck Basket, Blu Dot
- Mooi Rug
- Designtex performance textiles

Details

1. Convey's spectrum of modular components support smart space planning and can be used in conjunction to a variety of settings.
2. Motif ceramic steel provides a surface to jot down thoughts and key discussion points.



* Steelcase Health brand items are tested to BIFMA standards, are HHI compliant and are designed to be clinically appropriate and support patient safety and infection prevention protocols. However, some of the ancillary items shown in this application may or may not be appropriate for your specific clinical space or adhere to your facilities cleaning protocols. Please weigh each of these ancillary items on their own merit for use in your facility.

PRIVATE OFFICE 4

PO_4B

Application Includes

- Convey modular casework
- Gesture seating
- Motif wall panel
- Joel seating
- Campfire Paper Table
- Ancillary additions*
- Splash Coat Rack, Blu Dot
- Double Tuck Basket, Blu Dot
- Mooi Rug
- Designtex performance textiles

Details

1. Coat hooks are a welcome addition to any space as they hold coats, purses and backpacks.
2. Technology plays an important role in both teaching and learning and should be viewed by all users in the space.
3. Greenery brings in biophilic principles and can reduce stress and anxiety.



* Steelcase Health brand items are tested to BIFMA standards, are HHI compliant and are designed to be clinically appropriate and support patient safety and infection prevention protocols. However, some of the ancillary items shown in this application may or may not be appropriate for your specific clinical space or adhere to your facilities cleaning protocols. Please weigh each of these ancillary items on their own merit for use in your facility.

PRIVATE OFFICE 5



Concept

This shared office functions as a work and meeting space. Combining both functions in one shared space is a good way to maximize the real estate available.

PRIVATE OFFICE 5

PO_5A

Application Includes

- Elective Elements
- FlexFrame
- Gesture seating
- Less Than Five seating
- Ancillary additions*
- Half Dipped Vase, Big Bulb, West Elm
- Half Dipped Vase, Tall Tapered, West Elm
- Faceted Terrarium, West Elm

Details

1. FlexFrame allows maximization of vertical space Shelves and storages provided within easy access.
2. An adjustable height surface allows users control over their posture throughout the day.



* Steelcase Health brand items are tested to BIFMA standards, are HHI compliant and are designed to be clinically appropriate and support patient safety and infection prevention protocols. However, some of the ancillary items shown in this application may or may not be appropriate for your specific clinical space or adhere to your facilities cleaning protocols. Please weigh each of these ancillary items on their own merit for use in your facility.

PRIVATE OFFICE 5

PO_5B

Application Includes

- Elective Elements
- FlexFrame
- Gesture seating
- Less Than Five seating
- Ancillary additions*
- Half Dipped Vase, Big Bulb, West Elm
- Half Dipped Vase, Tall Tapered, West Elm
- Faceted Terrarium, West Elm

Details

1. Technology plays an important role. Used for both teaching and learning, it should be visually accessible to all users.
2. Coat hooks are a welcome addition to any consultation space as they hold many personal items.



** Steelcase Health brand items are tested to BIFMA standards, are HHI compliant and are designed to be clinically appropriate and support patient safety and infection prevention protocols. However, some of the ancillary items shown in this application may or may not be appropriate for your specific clinical space or adhere to your facilities cleaning protocols. Please weigh each of these ancillary items on their own merit for use in your facility.*

PRIVATE OFFICE 6



Concept

This space functions as both a private office and consultation setting. A monitor is placed on the wall, allowing effective sharing of information. Whiteboards are incorporated to aid in analog learning.

PRIVATE OFFICE 6

PO_6A

Application Includes

- Wishbone, Carl Hansen
- Verlay table
- Convey modular casework
- Elective Elements
- Universal Lateral Storage
- Motif wall panel
- Ancillary additions*
- Skygarden, Flos
- Array Bowl, Mitchell Gold + Bob Williams

Details

1. Back painted glass allows users to jot down notes and “to-do’s”.
2. Coat hooks are a welcome addition to the space for storage of personal items.
3. Universal lateral file with cushion top duals as a side seat for impromptu meetings.



* Steelcase Health brand items are tested to BIFMA standards, are HHI compliant and are designed to be clinically appropriate and support patient safety and infection prevention protocols. However, some of the ancillary items shown in this application may or may not be appropriate for your specific clinical space or adhere to your facilities cleaning protocols. Please weigh each of these ancillary items on their own merit for use in your facility.

Application Includes

- Wishbone, Carl Hansen
- Verlay table
- Convey modular casework
- Elective Elements
- Universal Lateral Storage
- Motif wall panel
- Ancillary additions*
- Skygarden, Flos
- Array Bowl, Mitchell Gold + Bob Williams

Details

1. Motif ceramic steel provides a surface to jot down thoughts and key discussion points.
2. Easy access to outlets permits users to work without fear of draining a battery.
3. Technology plays an important role in the space. It is a tool used for both teaching and learning and should be able to be viewed by all users.



Clinical Team Spaces

As the healthcare industry undergoes rapid change, the care team is often stretched thin, working in noisy, busy environments.

For organizations that are actively driving improvement through their operations, clinician workplaces can be a strategic asset supporting a more effective organization.

Considering the cognitive, physical and emotional needs of the care staff, can reduce the risk of costly errors and staff burnout.

<https://www.steelcase.com/research/articles/topics/medical-exam-room/new-exam-room-experience/>

<https://www.steelcase.com/spaces-inspiration/health-spaces-exam/>

<https://www.steelcase.com/research/articles/shared-decision-making-a-method-to-creating-positive-outcomes/>



SHARED PROVIDER 1

Conceptual Floorplan 1



Concept

Wellbeing can be enhanced when offering a variety of postures. This encourages end-users to move throughout the day. Each application is strategically placed, encouraging a logical flow throughout the workspace.

SHARED PROVIDER 1

SW_1A

Application Includes

- Answer Fence
 - Ology desk
 - Amia seating
 - Convey modular casework
 - Big Table
 - Last Minute stool
 - Regard seating
 - Exponents mobile media
- Ancillary additions*
- Blu Dot | Splash Coat Rack
 - Flos | Fucsia Pendant

Details

1. Screens provide seated height privacy, yet still allows users to feel connected to their surroundings.
2. Campfire Big Table creates a social area for casual meetings or work. It can also function as a space to take a break during the day.
3. Mobile whiteboard promotes sharing analog content and encourages collaboration.



* Steelcase Health brand items are tested to BIFMA standards, are HHI compliant and are designed to be clinically appropriate and support patient safety and infection prevention protocols. However, some of the ancillary items shown in this application may or may not be appropriate for your specific clinical space or adhere to your facilities cleaning protocols. Please weigh each of these ancillary items on their own merit for use in your facility.

SHARED PROVIDER 1

SW_1B

Application Includes

- Embold seating
- Last Minute stool
- V.I.A. modular wall
- Embold table
- Elective Elements
- B-Free ottoman
- Skate Table

Details

1. With a range of postures, this large collaborative setting encourages content sharing.
2. Standing height tables offer employees choice, control, and a variety of postures to help them remain engaged.
3. Open shelving units provide additional storage and creates visual interest in the space.



* Steelcase Health brand items are tested to BIFMA standards, are HHI compliant and are designed to be clinically appropriate and support patient safety and infection prevention protocols. However, some of the ancillary items shown in this application may or may not be appropriate for your specific clinical space or adhere to your facilities cleaning protocols. Please weigh each of these ancillary items on their own merit for use in your facility.

SHARED PROVIDER 1

SW_1C

Application Includes

- Regard seating
- Gesture seating
- Ology desk
- V.I.A. modular wall

Ancillary additions*

- Flos | Ktribe Pendant

Details

1. Ology tables provide users choice and control over their posture, ultimately supporting employee wellbeing.
2. V.I.A. provides true acoustical privacy for employees in adjacent workspaces.



* Steelcase Health brand items are tested to BIFMA standards, are HHI compliant and are designed to be clinically appropriate and support patient safety and infection prevention protocols. However, some of the ancillary items shown in this application may or may not be appropriate for your specific clinical space or adhere to your facilities cleaning protocols. Please weigh each of these ancillary items on their own merit for use in your facility.

SHARED PROVIDER 1

SW_1D

Application Includes

- Convey modular casework
- Elective Elements
- Embold seating

Details

1. Convey provides storage and an opportunity for nourishment and social interaction.
2. Comfortable touchdown seating is provided upon entrance of the space.



* Steelcase Health brand items are tested to BIFMA standards, are HHI compliant and are designed to be clinically appropriate and support patient safety and infection prevention protocols. However, some of the ancillary items shown in this application may or may not be appropriate for your specific clinical space or adhere to your facilities cleaning protocols. Please weigh each of these ancillary items on their own merit for use in your facility.

SHARED PROVIDER 2

Conceptual Floorplan 2



Concept

Clinicians excel in spaces that are designed to support focus work and collaboration. Monitors and whiteboards encourage teamwork and support content sharing within each zone.

Application Includes

- Convey modular casework
- Media:Scape
- Gesture seating
- FrameOne bench
- V.I.A. modular wall
- Exponents mobile media

Details

1. Benching applications support users to touchdown when they chose, while still providing adjacent users visual privacy. An integrated monitor encourages collaboration by sharing information with the remainder of the team.
2. Documents and files are located in storage at the end, allowing the desk surface to remain free of clutter.
3. Storage for work supplies and printers are located nearby, increasing efficiency and convenience in the space.



SHARED PROVIDER 2

SW_2B

Application Includes

- FrameOne bench
- Groupwork Mobile Markerboard
- Node chair
- Media:Scape

Details

1. Media:Scape thoughtfully integrates technology and furniture to create a system that can integrate with existing infrastructure.
2. This setting leverages both analog and digital information to foster collaboration.
3. Whiteboards encourage active analog sharing.



SHARED PROVIDER 2

SW_2C

Application Includes

- Convey modular casework
- Elective Elements
- Campfire stool
- Gesture seating
- Ology desk
- Umami seating
- V.I.A. modular wall
- Regard planter

Details

1. Phone booths create a private space for employees to take quick calls or meetings.
2. A private office is provided for confidential or concentrated work. A height adjustable table offers users choice and control.
3. Open storage provides a space for frequently accessed items.
4. Umami lounge supports quick conversations for guests who enter the space.



SHARED PROVIDER 3

Conceptual Floorplan 3



Concept

Clinicians excel in spaces that are designed to support focus work and collaboration. Monitors and whiteboards encourage teamwork and support content sharing within each zone.

SHARED PROVIDER 3

SW_3A

Application Includes

- Embold seating and table
- Convey modular casework
- Amia seating
- Bivi frame
- Buoy seating
- Universal storage
- Ology desk
- Campfire Skate Table

Details

1. Storage is conveniently located to keep supplies close at hand.
2. The Bivi canopy creates scale, allowing for this setting to feel more intimate within an open space.
3. A lounge area is provided for users to have an informal meeting, and/or take a break throughout the day.



SHARED PROVIDER 3

SW_3B

Application Includes

- Regard booth
- Convey modular casework
- Amia seating
- Bivi frame
- Ology desk

Details

1. This common area encourages individuals to eat, socialize, and revitalize.
2. Self service amenities provide an additional attraction to the area. Convey provides storage and an opportunity for nourishment and social interaction.



SHARED PROVIDER 3

SW_3C

Application Includes

- | | |
|-----------------------------|-------------------------|
| • Potrero chair | Ancillary additions* |
| • LessThanFive | • Flos Chasen Pendant |
| • Elective Elements storage | • Saggreenlife |

Details

- | | |
|---|--|
| 1. Digital content encourages collaboration, while still maintaining a limited footprint. | 3. Plants provide biophilic opportunities and creates a division of space. |
| 2. Technology is readily available; power and data is easily accessible within the table. | |



* Steelcase Health brand items are tested to BIFMA standards, are HHI compliant and are designed to be clinically appropriate and support patient safety and infection prevention protocols. However, some of the ancillary items shown in this application may or may not be appropriate for your specific clinical space or adhere to your facilities cleaning protocols. Please weigh each of these ancillary items on their own merit for use in your facility.

SHARED PROVIDER 4

Conceptual Floorplan 4



Concept

Clinicians excel in spaces that are designed to support focus work and collaboration. Monitors and whiteboards encourage teamwork and support content sharing within each zone.

SHARED PROVIDER 4

SW_4A

Application Includes

- Regard seating
- V.I.A. modular wall
- Campfire slim table
- Move stool
- Designtex performance textiles

Details

1. The regard booth serves multiple functions: eating, studying, content sharing.
2. Regard's double-sided frame allows users to sit close to each other, while still maintaining a division of space.
3. Campfire slim table provides a place for plants, office materials, and personal belongings.
4. V.I.A. provides a private meeting room for confidential work located close to the entrance.



* Steelcase Health brand items are tested to BIFMA standards, are HHI compliant and are designed to be clinically appropriate and support patient safety and infection prevention protocols. However, some of the ancillary items shown in this application may or may not be appropriate for your specific clinical space or adhere to your facilities cleaning protocols. Please weigh each of these ancillary items on their own merit for use in your facility.

SHARED PROVIDER 4

SW_4B

Application Includes

- Elective elements
 - Ology desk
 - Media:Scape
 - V.I.A. modular wall
 - Gesture seating
- Regard bench

Details

1. This space supports small team meetings with integrated technology.
2. V.I.A. walls ensure acoustical privacy and define meeting space.
3. An open workstation is provided for staff or can be used as a touchdown space when needed.



SHARED PROVIDER 4

SW_4C

Application Includes

- Media:Scape
- Convey modular wall
- Enea stool
- Regard seating
- V.I.A.modular wall

Details

1. The media:scape lounge system's geometric, modular design enables teams to comfortably connect and easily collaborate.
2. Shared open storage offers convenient access to commonly used items and resources.



SHARED PROVIDER 4

SW_4D

Application Includes

- FrameOne bench
- Amia seating
- Exponents mobile media
- Montara table
- Enea Stool
- Flex collection
- Regard seating

Details

1. Exponents mobile media allows flexibility within the space; providing users the opportunity to display content as needed.
2. Team members have the opportunity to quickly touchdown or collaborate with each other to share research and insights.
3. Enea table provides a spot for impromptu meetings and/or quick collaboration.



SHARED PROVIDER 5

Conceptual Floorplan 5



Concept

Demountable walls allow for division of space, without having to integrate permanent architecture. The project team space in the center allows for users to switch between tasks, creating a small touch down area between heads down work and team meetings.

SHARED PROVIDER 5

SW_5A

Application Includes

- Convey modular casework
- Answer panel
- Universal storage
- C:Scape table
- FrameOne bench
- V.I.A. modular wall
- Amia seating
- Regard planter

Details

1. Meeting space is provided for impromptu short-term meetings, allowing users to remain visible to co-workers within the office.
2. Universal lateral file cabinets support office materials needed within the space.



SHARED PROVIDER 5

SW_5B

Application Includes

- Convey modular casework
- Answer panel
- Universal storage
- C:Scape table
- FrameOne bench
- V.I.A. modular wall
- Amia seating

Details

1. Low architectural walls promote an open plan concept, while still providing a barrier between zones.
2. FrameOne benching allows users to touchdown and focus on heads down work or provides the opportunity for group content sharing.



SHARED PROVIDER 5

SW_5C

Application Includes

- Convey modular casework
- Answer panel
- Universal storage
- C:Scape table
- Node chair
- FrameOne bench
- V.I.A. modular wall
- Amia seating
- Flex collection
- Regard planter

Details

1. Team Studio provides access to digital and analog content, while offering a variety of postures. This allows users to maintain the same level of eye contact while sitting or standing.
2. Whiteboards encourage collaboration and innovation among the team.



SHARED PROVIDER 6

Conceptual Floorplan 6

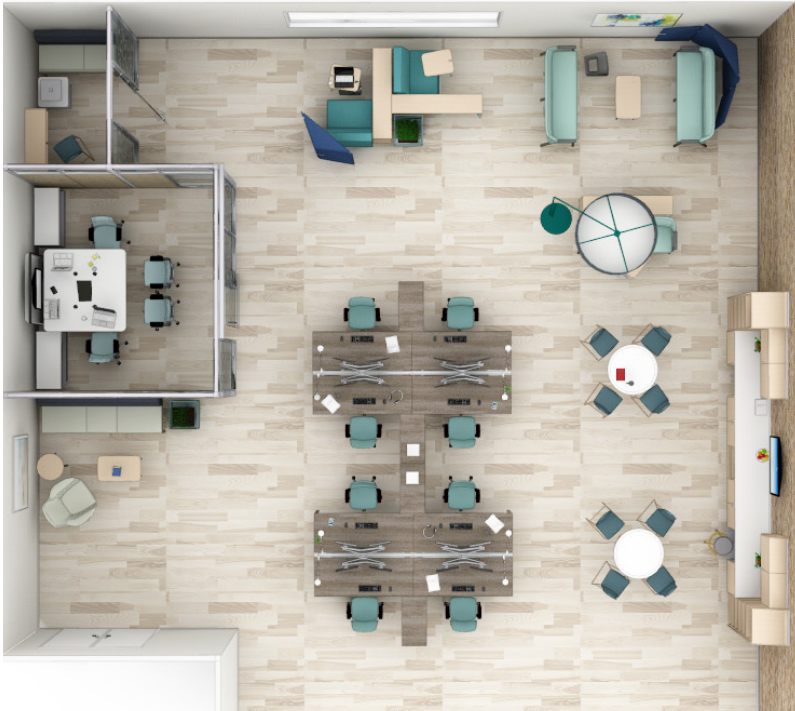

Concept

This space is multi-use: allowing employees to work, socialize, collaborate and recharge. In turn, this creates a human-centered approach by encouraging wellbeing, individual choice and team performance.

SHARED PROVIDER 6

SW_6A

Application Includes

- Amia seating
- FrameOne bench
- V.I.A. modular wall

Details

1. This FrameOne bench encourages conversation among employees. A shared return surface allows space for piling and personal belongings.
2. Strategic placing of benching allows ample room for users to flow freely throughout the space.



SHARED PROVIDER 6

SW_6B

Application Includes

- Convey modular casework
- Montara stool
- Montara table

Details

1. Standing height tables provide opportunity for impromptu meetings or an agile perching space.
2. Common area creates a space for employees to socialize, eat and rejuvenate.
3. Storage is strategically placed near-by for office supplies and informational resources. This allows users immediate access to frequently used items.



SHARED PROVIDER 6

SW_6C

Application Includes

- Embold seating
 - Campfire Big Lamp
 - Campfire Half Lounge
 - Campfire Slim Table
 - Clipper
- Skate Table

Details

1. Individual space for employees to focus on concentrated work.
2. Clipper screens provide employees the opportunity of additional privacy when needed. When not in use, screens can be folded up and stowed away. Note: clipper upholstery must be bleach cleanable.
3. Shared setting that creates a relaxing atmosphere for either socializing or rejuvenating.



SHARED PROVIDER 7

Conceptual Floorplan 7



Concept

This zone is in a convenient location for clinicians to easily access. The area provides space for concentration, socialization, and collaboration for employees to make the most of their break time.

SHARED PROVIDER 7

SW_7A

Application Includes

- Sync workstation
- Opus casework
- Gesture seating
- Bivi workstation
- Move chair
- Media:Scape
- Regard booth

Details

1. A double-sided base with a standing height surface creates an approachable space for visitors. A display is provided for guests to easily access information.
2. V.I.A wall creates a barrier for visitors while still allowing transparency within the space.

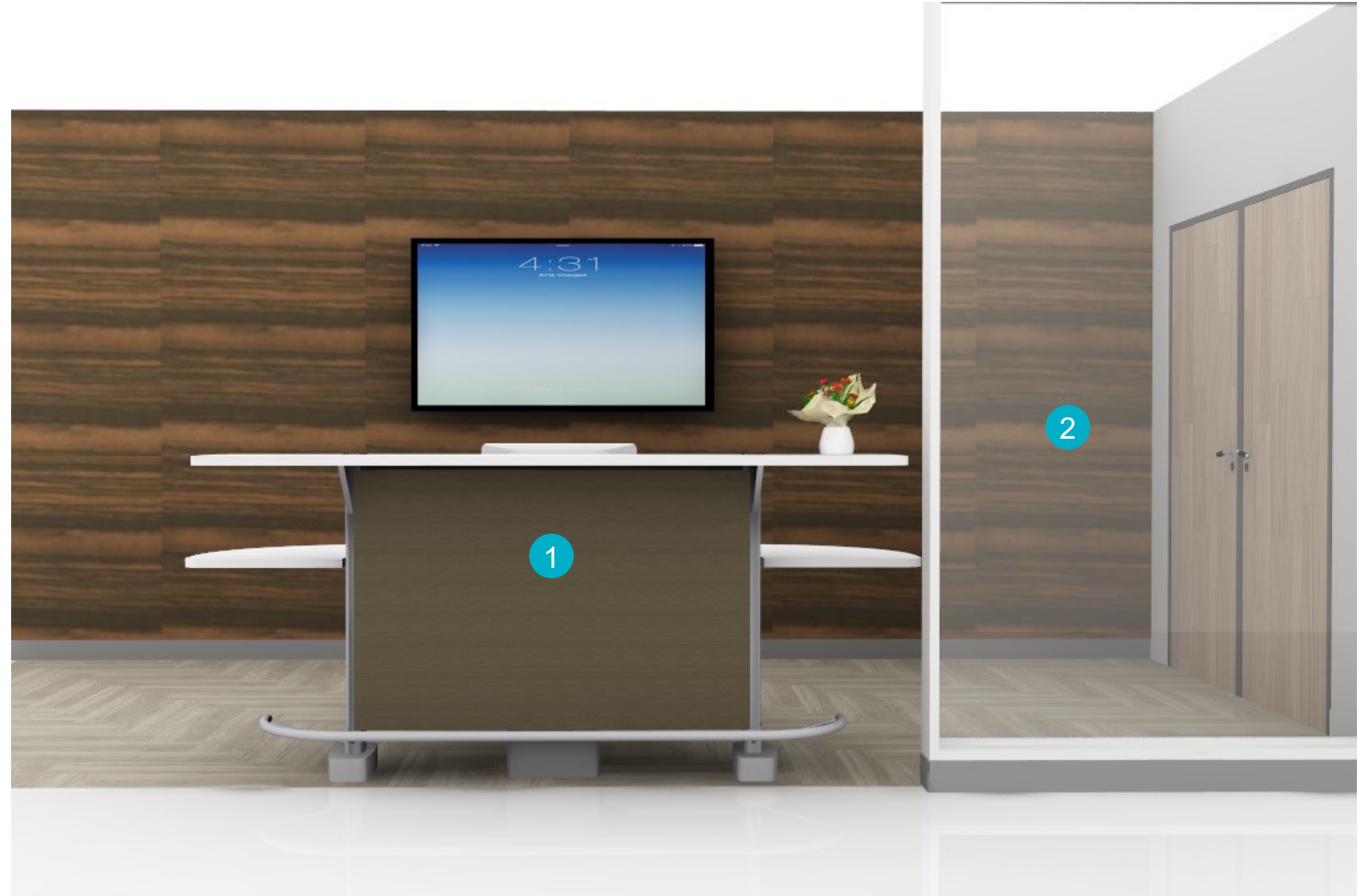

Application Includes

- Sync workstation
- Opus casework
- Gesture seating
- Bivi workstation
- Move chair
- Media:Scape
- Regard booth

Details

1. Monitor mount allows users to collaborate by sharing digital content.
2. Benching promotes the open plan concept, allowing the space to feel accessible and collaborative.
3. Opus provides additional storage, meeting space, and technology integration.



SHARED PROVIDER 7

SW_7C

Application Includes

- Sync workstation
- Opus casework
- Gesture seating
- Bivi Workstation
- Move chair
- Media:Scape
- Regard booth
- Designtex performance textiles

Details

1. Regard booth provides visual privacy in the space. Technology integration supports collaborative share.
2. Greenery enhances user wellbeing by incorporating biophilic elements within the space.



SHARED PROVIDER 8

Conceptual Floorplan 8



Concept

This space was created as a centralized workspace for clinicians to perform heads down tasks. Clinicians can review and archive information pre and post consultation within proximity of exam rooms.

SHARED PROVIDER 8

SW_8A

Application Includes

- Elective Elements
- Ology desk
- Amia seating
- Convey modular casework
- Designtex performance textiles

Details

1. Elective Elements wall mounted storage functions as additional piling space and a markerboard for note taking.
2. Back to back desks minimize the workstation footprint and promotes easy collaboration.



SHARED PROVIDER 8

SW_8B

Application Includes

- Convey modular casework

Details

1. Wardrobe tower and shelving provides clinical staff a space to hang coats and store additional resources out of sight.
2. Convey provides locker opportunities for employees to store and lock personal items.



SHARED PROVIDER 9

Conceptual Floorplan 9



Concept

This shared provider workspace allows end-users to work collaboratively and provides visual access to all team members. A variety of postures are incorporated, allowing employees additional opportunity for choice and control.

Application Includes

- Convey modular casework
- Buoy seating
- Silq seating
- Bivi frame
- Irys Pod
- Ology desk
- Regard planter

Details

1. Bivi frames support height adjustable desks, allowing all users to be ergonomic regardless of varying heights.
2. Convey storage allows for personal belongings and office supplies to be concealed and lockable.



SHARED PROVIDER 9

SW_9b

Application Includes

- Irys Pod
- Bob seating
- B-Free ottoman
- Regard bench
- Embold seating and table
- Elective elements storage
- Splash Coat Rack, Blu Dot
- Designtex performance textiles

Details

1. Comfortable lounge area for casual meetings or rejuvenation.
2. Irys Pod provides an opportunity for individual focused work or small-group collaborative work.
3. Potrero table incorporates integrated electrical, allowing users to power up personal devices.



SHARED PROVIDER 9

SW_9c

Application Includes

- Brody worklounge
- Think seating

Details

1. A smart alternative to enclaves, the Brody WorkLounge is a private lounge chair that transforms under-utilized in-between spaces into covetable destinations.
2. Through the combination of ergonomic comfort, visual privacy, personal storage and lighting, Brody WorkLounge creates a comfortable microenvironment so users can focus their attention, get into flow and get work done.



SHARED PROVIDER 10

Conceptual Floorplan 10

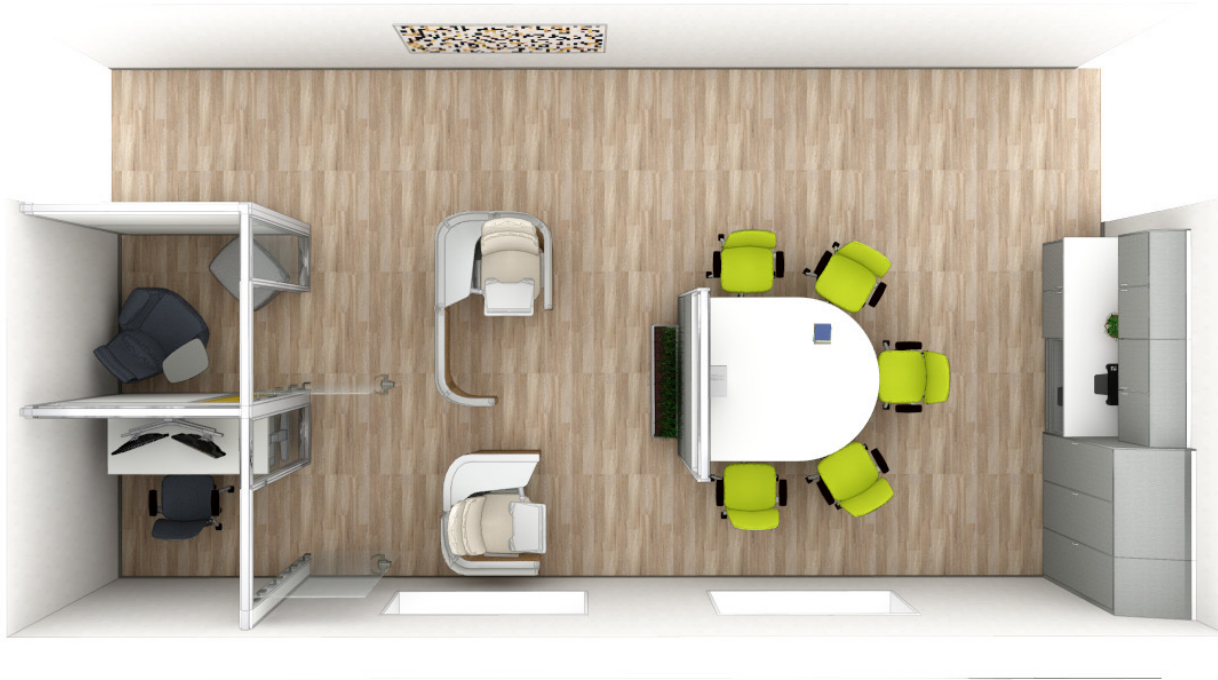

Concept

Clinicians have the opportunity to concentrate on heads-down work, collaborate in small groups, or lounge in a Brody. Various postures are provided, giving employees choice and control over how and where they work.

Application Includes

- Convey modular casework
- Amia seating
- Media:Scape
- V.I.A. modular wall

Details

1. This meeting space encourages teams to collaborate. Media:Scape incorporates integrated technology, allowing users to connect and display content easily and efficiently.
2. Wall mounted storage provides a place for office materials.



Application Includes

- Amia seating
- V.I.A. modular wall
- Brody workstation
- Universal pedestal
- Ology desk

Details

1. Height adjustable table provides users choice and control over their posture, improving worker wellbeing.
2. Brody lounges provide visual privacy, allowing clinicians to focus on heads down tasks.



Steelcase®
HEALTH